

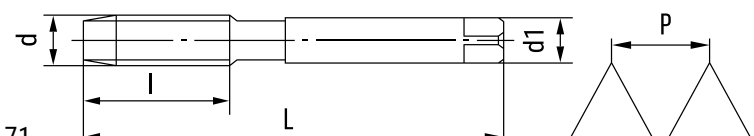

МЕТЧИК ГАЕЧНЫЙ ДЛЯ МЕТРИЧЕСКОЙ РЕЗЬБЫ

HORTZ



Материал: быстрорежущая сталь Р6М5 ГОСТ 1604-71

КОД	d/P	L	l	d1
837296	M3x0.5	70	10	2.24
837299	M4x0.7	90	14	2.80
837302	M5x0.8	110	16	3.55
837304	M6x1.0	120	20	4.50
837305	M8x0.75	140	16	6.30
837306	M8x1	140	20	6.30
837307	M8x1.25	140	25	6.30
837309	M10x1	160	20	8.00
837308	M10x1.25	160	25	8.00
837310	M10x1.5	160	30	8.00
837311	M12x1	180	20	9.00
837312	M12x1.25	180	25	9.00
837313	M12x1.5	180	30	9.00
837314	M12x1.75	180	36	9.00
837315	M14x1	180	20	10.00
837316	M14x1.5	180	30	10.00
837317	M14x2	180	40	10.00
837319	M16x1	200	20	12.50
837320	M16x1.5	200	30	12.50
837321	M16x2	200	40	12.50
837322	M18x1	200	20	14.00

КОД	d/P	L	l	d1
837324	M18x1.5	200	30	14.00
837325	M18x2	200	40	14.00
837326	M18x2.5	200	50	14.00
837327	M20x1.5	220	30	16.00
837328	M20x2	220	40	16.00
837329	M20x2.5	220	50	16.00
837330	M22x1.5	220	30	18.00
837331	M22x2	220	40	18.00
837332	M22x2.5	220	50	18.00
837333	M24x1.5	250	30	18.00
837334	M24x2	250	40	18.00
837335	M24x3	250	60	18.00
837337	M27x1.5	250	30	20.00
837338	M27x2	250	40	20.00
837339	M27x3	250	60	20.00
837340	M30x1.5	280	30	22.40
837341	M30x2	280	40	22.40
837342	M30x3	280	60	22.40
837343	M30x3.5	280	70	22.40

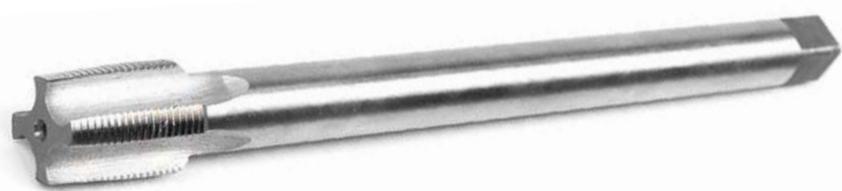

ФРЕЗЫ КОНЦЕВЫЕ Ц/Х HORTZ

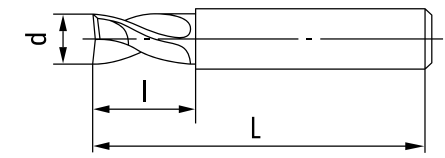

Материал: быстрорежущая сталь Р6М5 ГОСТ 17025-71

КОД	d	L	l	ЧИСЛО ЗУБЬЕВ
351904	3	40	8	4
351905	4	43	11	4
351906	5	47	13	4
351907	6	57	13	4
351908	7	60	16	4
351909	8	63	19	4
351911	9	69	19	4
351912	10	72	22	4
351913	12	83	26	4
351914	12	83	26	5
351915	14	83	26	5
351917	16	92	32	5
351918	18	92	32	6
351919	20	104	38	6
351920	22	104	38	6
351921	25	121	45	6
351922	28	121	45	6



ФРЕЗЫ КОНЦЕВЫЕ К/Х HORTZ

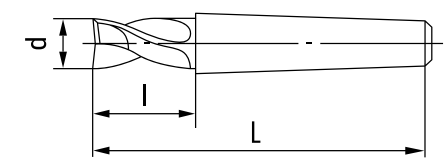

Материал: быстрорежущая сталь Р6М5 ГОСТ 17026-71

КОД	d	L	l	ЧИСЛО ЗУБЬЕВ	КМ
351875	10	92	22	4	1
351876	12	96	26	4	1
351877	12	111	26	4	2
351878	14	96	26	4	1
351879	14	111	26	4	2
351880	16	117	32	4	2
351881	18	117	32	4	2
351882	20	123	38	5	2
351883	20	140	38	5	3
351884	22	123	38	5	2
351885	22	140	38	5	3
351886	25	147	45	5	3
351887	28	147	45	3	3
463316	28	147	45	5	3
351888	28	170	45	5	4
351889	32	155	53	6	3
351890	32	178	53	6	4
351891	36	155	53	6	3
351892	36	178	53	6	4
351893	40	188	63	6	4
351894	40	221	63	6	5
351895	45	188	63	6	4
351896	45	221	63	6	5
351897	50	200	75	6	4
351898	50	233	75	6	5
351899	56	200	75	8	4
351900	56	233	75	8	5
351901	63	248	90	8	5





ФРЕЗЫ ОТРЕЗНЫЕ HÖRTZ

КОД	МОДЕЛЬ	КОД	МОДЕЛЬ	КОД	МОДЕЛЬ	КОД	МОДЕЛЬ	КОД	МОДЕЛЬ		
204177	20x0.3x5 т.1 z64 P6M5 HOR	204225	32x1.4x8 т.1 z48 P6M5 HOR	204968	40x4x10 т.2 z20 P6M5 HOR	205141	63x0.5x16 т.2 z64 P6M5 HOR	205273	80x1.4x22 т.2 z48 P6M5 HOR	205620	100x1.4x22 т.1 z100 P6M5 HOR
204178	20x0.4x5 т.1 z64 P6M5 HOR	204226	32x1.6x8 т.1 z48 P6M5 HOR	204969	40x5x10 т.1 z40 P6M5 HOR	205144	63x0.6x16 т.1 z100 P6M5 HOR	205274	80x1.6x22 т.1 z100 P6M5 HOR	205621	100x1.4x22 т.2 z64 P6M5 HOR
204179	20x0.5x5 т.1 z48 P6M5 HOR	204227	32x1.6x8 т.2 z24 P6M5 HOR	204971	50x0.3x13 т.1 z128 P6M5 HOR	205145	63x0.6x16 т.2 z48 P6M5 HOR	205275	80x1.6x22 т.2 z48 P6M5 HOR	205698	100x1.4x27 т.1 z100 P6M5 HOR
204180	20x0.6x5 т.1 z48 P6M5 HOR	204228	32x2x8 т.1 z48 P6M5 HOR	204972	50x0.3x13 т.2 z64 P6M5 HOR	205146	63x0.8x16 т.1 z100 P6M5 HOR	205352	80x2x22 т.1 z80 P6M5 HOR	205699	100x1.4x27 т.2 z64 P6M5 HOR
204181	20x0.8x5 т.1 z48 P6M5 HOR	204229	32x2x8 т.2 z24 P6M5 HOR	204973	50x0.4x13 т.1 z100 P6M5 HOR	205148	63x0.8x16 т.2 z48 P6M5 HOR	205353	80x2x22 т.2 z40 P6M5 HOR	205622	100x1.6x22 т.1 z100 P6M5 HOR
204182	20x1x5 т.1 z40 P6M5 HOR	477097	32x2x8 тип 2 z=40 P6M5 HOR	204974	50x0.4x13 т.2 z48 P6M5 HOR	205149	63x1x16 т.1 z100 P6M5 HOR	205356	80x2.5x22 т.1 z80 P6M5 HOR	205623	100x1.6x22 т.2 z48 P6M5 HOR
204183	20x1.2x5 т.1 z40 P6M5 HOR	204230	32x2.5x8 т.1 z40 P6M5 HOR	204975	50x0.5x13 т.1 z100 P6M5 HOR	205150	63x1x16 т.2 z48 P6M5 HOR	205357	80x2.5x22 т.2 z40 P6M5 HOR	205700	100x1.6x27 т.1 z100 P6M5 HOR
204184	20x1.4x5 т.1 z40 P6M5 HOR	204231	32x2.5x8 т.2 z20 P6M5 HOR	204976	50x0.5x13 т.2 z48 P6M5 HOR	205152	63x1.2x16 т.1 z80 P6M5 HOR	205359	80x2.8x22 т.1 z80 P6M5 HOR	205701	100x1.6x27 т.2 z48 P6M5 HOR
204185	20x1.6x5 т.1 z40 P6M5 HOR	204232	32x2.8x8 т.1 z40 P6M5 HOR	204977	50x0.6x13 т.1 z100 P6M5 HOR	205153	63x1.2x16 т.2 z40 P6M5 HOR	205360	80x2.8x22 т.2 z40 P6M5 HOR	205626	100x2x22 т.1 z100 P6M5 HOR
204186	20x2x5 т.1 z32 P6M5 HOR	204234	32x3x8 т.1 z40 P6M5 HOR	204978	50x0.6x13 т.2 z48 P6M5 HOR	205156	63x1.4x16 т.1 z80 P6M5 HOR	205361	80x3x22 т.1 z80 P6M5 HOR	205628	100x2x22 т.2 z48 P6M5 HOR
204187	20x2.5x5 т.1 z32 P6M5 HOR	204233	32x3x8 т.2 z20 P6M5 HOR	204989	50x0.8x13 т.1 z80 P6M5 HOR	205157	63x1.4x16 т.2 z40 P6M5 HOR	205362	80x3x22 т.2 z40 P6M5 HOR	205704	100x2x27 т.1 z100 P6M5 HOR
204190	25x0.3x8 т.1 z80 P6M5 HOR	204235	32x4x8 т.1 z40 P6M5 HOR	204990	50x0.8x13 т.2 z40 P6M5 HOR	205158	63x1.6x16 т.1 z80 P6M5 HOR	205599	80x3.5x22 т.2 z40 P6M5 HOR	205705	100x2x27 т.2 z48 P6M5 HOR
204191	25x0.4x8 т.1 z64 P6M5 HOR	204236	40x0.2x10 т.1 z128 P6M5 HOR	204991	50x1x13 т.1 z80 P6M5 HOR	205159	63x1.6x16 т.2 z40 P6M5 HOR	205600	80x4x22 т.1 z64 P6M5 HOR	205666	100x2.5x22 т.1 z100 P6M5 HOR
204192	25x0.5x8 т.1 z64 P6M5 HOR	204238	40x0.3x10 т.1 z100 P6M5 HOR	204992	50x1x13 т.2 z40 P6M5 HOR	205162	63x2x16 т.1 z80 P6M5 HOR	205603	80x4x22 т.2 z32 P6M5 HOR	205667	100x2.5x22 т.2 z48 P6M5 HOR
204193	25x0.6x8 т.1 z64 P6M5 HOR	204239	40x0.3x10 т.2 z48 P6M5 HOR	205102	50x1.2x13 т.1 z80 P6M5 HOR	205163	63x2x16 т.2 z40 P6M5 HOR	205596	80x5x22 т.1 z64 P6M5 HOR	205709	100x2.5x27 т.1 z100 P6M5 HOR
204194	25x0.8x8 т.1 z48 P6M5 HOR	204240	40x0.4x10 т.1 z100 P6M5 HOR	205103	50x1.2x13 т.2 z40 P6M5 HOR	205164	63x2x16 т.3 z20 P6M5 HOR	205595	80x5x22 т.2 z32 P6M5 HOR	205710	100x2.5x27 т.2 z48 P6M5 HOR
204195	25x1x8 т.1 z48 P6M5 HOR	204241	40x0.4x10 т.2 z48 P6M5 HOR	205105	50x1.4x13 т.1 z80 P6M5 HOR	205166	63x2.5x16 т.1 z64 P6M5 HOR	205604	80x6x22 т.1 z64 P6M5 HOR	205670	100x2.8x22 т.1 z100 P6M5 HOR
204196	25x1.2x8 т.1 z48 P6M5 HOR	204242	40x0.5x10 т.1 z80 P6M5 HOR	205106	50x1.4x13 т.2 z40 P6M5 HOR	205167	63x2.5x16 т.2 z32 P6M5 HOR	205605	80x6x22 т.2 z32 P6M5 HOR	205671	100x2.8x22 т.2 z48 P6M5 HOR
204199	25x1.4x8 т.1 z48 P6M5 HOR	204243	40x0.5x10 т.2 z40 P6M5 HOR	205107	50x1.6x13 т.1 z64 P6M5 HOR	205170	63x2.8x16 т.1 z64 P6M5 HOR	205606	100x0.5x22 т.1 z160 P6M5 HOR	205713	100x2.8x27 т.1 z100 P6M5 HOR
204198	25x1.6x8 т.1 z40 P6M5 HOR	204244	40x0.6x10 т.1 z80 P6M5 HOR	205108	50x1.6x13 т.2 z32 P6M5 HOR	205171	63x2.8x16 т.2 z32 P6M5 HOR	205607	100x0.5x22 т.2 z64 P6M5 HOR	205714	100x2.8x27 т.2 z48 P6M5 HOR
450255	25x2x8 тип 1 z40 P6M5 HOR	204245	40x0.6x10 т.2 z40 P6M5 HOR	205110	50x2x13 т.1 z64 P6M5 HOR	205172	63x3x16 т.1 z64 P6M5 HOR	205683	100x0.5x27 т.1 z160 P6M5 HOR	205672	100x3x22 т.1 z80 P6M5 HOR
204202	25x2.5x8 т.1 z40 P6M5 HOR	204246	40x0.8x10 т.1 z80 P6M5 HOR	205111	50x2x13 т.2 z32 P6M5 HOR	205173	63x3x16 т.2 z32 P6M5 HOR	205685	100x0.5x27 т.2 z64 P6M5 HOR	205673	100x3x22 т.2 z40 P6M5 HOR
204201	25x2.8x8 т.1 z40 P6M5 HOR	204247	40x0.8x10 т.2 z40 P6M5 HOR	205113	50x2.5x13 т.1 z64 P6M5 HOR	205253	63x4x16 т.1 z64 P6M5 HOR	205608	100x0.6x22 т.1 z160 P6M5 HOR	205715	100x3x27 т.1 z80 P6M5 HOR
204203	25x3x8 т.1 z32 P6M5 HOR	204248	40x1x10 т.1 z64 P6M5 HOR	205114	50x2.5x13 т.2 z32 P6M5 HOR	205254	63x4x16 т.2 z32 P6M5 HOR	205609	100x0.6x22 т.2 z64 P6M5 HOR	205716	100x3x27 т.2 z40 P6M5 HOR
204208	32x0.3x8 т.1 z80 P6M5 HOR	204255	40x1x10 т.2 z32 P6M5 HOR	205116	50x2.8x13 т.1 z64 P6M5 HOR	205255	63x5x16 т.1 z48 P6M5 HOR	205684	100x0.6x27 т.1 z160 P6M5 HOR	205676	100x3.5x22 т.2 z40 P6M5 HOR
204210	32x0.3x8 т.2 z40 P6M5 HOR	204955	40x1.2x10 т.1 z64 P6M5 HOR	205117	50x2.8x13 т.2 z32 P6M5 HOR	205256	63x5x16 т.2 z24 P6M5 HOR	205687	100x0.6x27 т.2 z64 P6M5 HOR	205718	100x3.5x27 т.2 z40 P6M5 HOR
204211	32x0.4x8 т.1 z80 P6M5 HOR	204956	40x1.2x10 т.2 z32 P6M5 HOR	205118	50x3x13 т.1 z48 P6M5 HOR	205257	63x6x16 т.1 z48 P6M5 HOR	205610	100x0.8x22 т.1 z128 P6M5 HOR	205677	100x4x22 т.1 z80 P6M5 HOR
204214	32x0.4x8 т.2 z40 P6M5 HOR	204957	40x1.4x10 т.1 z64 P6M5 HOR	205121	50x3x13 т.2 z24 P6M5 HOR	205258	63x6x16 т.2 z24 P6M5 HOR	205611	100x0.8x22 т.2 z64 P6M5 HOR	205678	100x4x22 т.2 z40 P6M5 HOR
204215	32x0.5x8 т.1 z80 P6M5 HOR	204958	40x1.6x10 т.1 z64 P6M5 HOR	205124	50x4x13 т.1 z48 P6M5 HOR	205259	80x0.5x22 т.1 z128 P6M5 HOR	205688	100x0.8x27 т.1 z128 P6M5 HOR	205719	100x4x27 т.1 z80 P6M5 HOR
204216	32x0.5x8 т.2 z40 P6M5 HOR	204959	40x1.6x10 т.2 z32 P6M5 HOR	205125	50x4x13 т.2 z24 P6M5 HOR	205260	80x0.6x22 т.1 z128 P6M5 HOR	205689	100x0.8x27 т.2 z64 P6M5 HOR	205721	100x4x27 т.2 z40 P6M5 HOR
204217	32x0.6x8 т.1 z64 P6M5 HOR	204960	40x2x10 т.1 z48 P6M5 HOR	205129	50x5x13 т.1 z48 P6M5 HOR	205261	80x0.6x22 т.2 z64 P6M5 HOR	205612	100x1x22 т.1 z128 P6M5 HOR	205679	100x5x22 т.1 z80 P6M5 HOR
204218	32x0.6x8 т.2 z32 P6M5 HOR	204961	40x2x10 т.2 z24 P6M5 HOR	205130	50x5x13 т.2 z24 P6M5 HOR	205262	80x0.8x22 т.1 z128 P6M5 HOR	205613	100x1x22 т.2 z64 P6M5 HOR	205680	100x5x22 т.2 z40 P6M5 HOR
204219	32x0.8x8 т.1 z64 P6M5 HOR	204962	40x2.5x10 т.1 z48 P6M5 HOR	205131	50x6x13 т.1 z48 P6M5 HOR	205263	80x0.8x22 т.2 z64 P6M5 HOR	205690	100x1x27 т.1 z128 P6M5 HOR	205722	100x5x27 т.1 z80 P6M5 HOR
204220	32x0.8x8 т.2 z32 P6M5 HOR	204963	40x2.5x10 т.2 z24 P6M5 HOR	205132	63x0.3x16 т.1 z128 P6M5 HOR	205264	80x1x22 т.1 z100 P6M5 HOR	205691	100x1x27 т.2 z64 P6M5 HOR	205723	100x5x27 т.2 z40 P6M5 HOR
204221	32x1x8 т.1 z64 P6M5 HOR	204964	40x2.8x10 т.1 z48 P6M5 HOR	205136	63x0.3x16 т.2 z64 P6M5 HOR	205265	80x1x22 т.2 z48 P6M5 HOR	205616	100x1.2x22 т.1 z128 P6M5 HOR	205681	100x6x22 т.1 z64 P6M5 HOR
204222	32x1x8 т.2 z32 P6M5 HOR	204965	40x3x10 т.1 z48 P6M5 HOR	205137	63x0.4x16 т.1 z128 P6M5 HOR	205268	80x1.2x22 т.1 z100 P6M5 HOR	205617	100x1.2x22 т.2 z64 P6M5 HOR	205682	100x6x22 т.2 z32 P6M5 HOR
204223	32x1.2x8 т.1 z48 P6M5 HOR	204966	40x3x10 т.2 z24 P6M5 HOR	205138	63x0.4x16 т.2 z64 P6M5 HOR	205269	80x1.2x22 т.2 z48 P6M5 HOR	205694	100x1.2x27 т.1 z128 P6M5 HOR	205724	100x6x27 т.1 z64 P6M5 HOR
204224	32x1.2x8 т.2 z24 P6M5 HOR	204967	40x4x10 т.1 z40 P6M5 HOR	205139	63x0.5x16 т.1 z128 P6M5 HOR	205272	80x1.4x22 т.1 z100 P6M5 HOR	205695	100x1.2x27 т.2 z64 P6M5 HOR	205725	100x6x27 т.2 z32 P6M5 HOR



КОД	МОДЕЛЬ	КОД	МОДЕЛЬ	КОД	МОДЕЛЬ
205726	125x0.8x22 т.1 z160 P6M5 HOR	205747	125x3x22 т.1 z100 P6M5 HOR	205810	160x2.5x32 т.2 z64 P6M5 HOR
205761	125x0.8x27 т.1 z160 P6M5 HOR	205748	125x3x22 т.2 z48 P6M5 HOR	205812	160x2.5x32 т.3 z22 P6M5 HOR
205727	125x1x22 т.1 z160 P6M5 HOR	205750	125x3x22 т.3 z18 P6M5 HOR	205811	160x2.5x32 т.3 z32 P6M5 HOR
205728	125x1x22 т.2 z80 P6M5 HOR	205749	125x3x22 т.3 z24 P6M5 HOR	205813	160x2.8x32 т.1 z128 P6M5 HOR
205763	125x1x27 т.1 z160 P6M5 HOR	205783	125x3x27 т.1 z100 P6M5 HOR	205814	160x2.8x32 т.2 z64 P6M5 HOR
205764	125x1x27 т.2 z80 P6M5 HOR	205784	125x3x27 т.2 z48 P6M5 HOR	205815	160x3x32 т.1 z128 P6M5 HOR
205729	125x1.2x22 т.1 z128 P6M5 HOR	205786	125x3x27 т.3 z18 P6M5 HOR	205816	160x3x32 т.2 z64 P6M5 HOR
205730	125x1.2x22 т.2 z64 P6M5 HOR	205785	125x3x27 т.3 z24 P6M5 HOR	205818	160x3 x32 т.3 z20 P6M5 HOR
205765	125x1.2x27 т.1 z128 P6M5 HOR	205751	125x3.5x22 т.2 z48 P6M5 HOR	205817	160x3x32 т.3 z32 P6M5 HOR
205766	125x1.2x27 т.2 z64 P6M5 HOR	205753	125x3.5x22 т.3 z18 P6M5 HOR	205819	160x3.5x32 т.2 z64 P6M5 HOR
205731	125x1.4x22 т.1 z128 P6M5 HOR	205752	125x3.5x22 т.3 z24 P6M5 HOR	205821	160x3.5x32 т.3 z20 P6M5 HOR
205732	125x1.4x22 т.2 z64 P6M5 HOR	205787	125x3.5x27 т.2 z48 P6M5 HOR	205820	160x3.5x32 т.3 z32 P6M5 HOR
205767	125x1.4x27 т.1 z128 P6M5 HOR	205789	125x3.5x27 т.3 z18 P6M5 HOR	205822	160x4x32 т.1 z100 P6M5 HOR
205768	125x1.4x27 т.2 z64 P6M5 HOR	205788	125x3.5x27 т.3 z24 P6M5 HOR	205823	160x4x32 т.2 z48 P6M5 HOR
205733	125x1.6x22 т.1 z128 P6M5 HOR	205754	125x4x22 т.1 z100 P6M5 HOR	205825	160x4x32 т.3 z20 P6M5 HOR
205734	125x1.6x22 т.2 z64 P6M5 HOR	205755	125x4x22 т.2 z48 P6M5 HOR	205824	160x4x32 т.3 z24 P6M5 HOR
205736	125x1.6x22 т.3 z22 P6M5 HOR	205757	125x4x22 т.3 z18 P6M5 HOR	205829	160x4.5x32 т.2 z48 P6M5 HOR
205735	125x1.6x22 т.3 z32 P6M5 HOR	205756	125x4x22 т.3 z24 P6M5 HOR	205831	160x4.5x32 т.3 z20 P6M5 HOR
205769	125x1.6x27 т.1 z128 P6M5 HOR	205790	125x4x27 т.1 z100 P6M5 HOR	205830	160x4.5x32 т.3 z24 P6M5 HOR
205770	125x1.6x27 т.2 z64 P6M5 HOR	205791	125x4x27 т.2 z48 P6M5 HOR	205832	160x5x32 т.1 z100 P6M5 HOR
205772	125x1.6x27 т.3 z22 P6M5 HOR	205793	125x4x27 т.3 z18 P6M5 HOR	205833	160x5x32 т.2 z48 P6M5 HOR
205771	125x1.6x27 т.3 z32 P6M5 HOR	205792	125x4x27 т.3 z24 P6M5 HOR	205834	160x5.5x32 т.2 z48 P6M5 HOR
205737	125x2x22 т.1 z128 P6M5 HOR	205758	125x5x22 т.1 z80 P6M5 HOR	205835	160x6x32 т.1 z100 P6M5 HOR
205738	125x2x22 т.2 z64 P6M5 HOR	205759	125x5x22 т.2 z40 P6M5 HOR	205836	160x6x32 т.2 z48 P6M5 HOR
205740	125x2x22 т.3 z20 P6M5 HOR	205794	125x5x27 т.1 z80 P6M5 HOR	205837	200x1.6x32 т.1 z160 P6M5 HOR
205739	125x2x22 т.3 z32 P6M5 HOR	205795	125x5x27 т.2 z40 P6M5 HOR	205839	200x1.6x32 т.2 z80 P6M5 HOR
205773	125x2x27 т.1 z128 P6M5 HOR	205760	125x6x22 т.1 z80 P6M5 HOR	205840	200x2x32 т.1 z160 P6M5 HOR
205774	125x2x27 т.2 z64 P6M5 HOR	205762	125x6x22 т.2 z40 P6M5 HOR	205841	200x2x32 т.2 z80 P6M5 HOR
205776	125x2x27 т.3 z20 P6M5 HOR	205796	125x6x27 т.1 z80 P6M5 HOR	205842	200x2x32 т.3 z40 P6M5 HOR
205775	125x2x27 т.3 z32 P6M5 HOR	205797	125x6x27 т.2 z40 P6M5 HOR	205844	200x2.5x32 т.1 z160 P6M5 HOR
205741	125x2.5x22 т.1 z100 P6M5 HOR	205798	160x1.2x32 т.1 z160 P6M5 HOR	205845	200x2.5x32 т.2 z80 P6M5 HOR
205742	125x2.5x22 т.2 z48 P6M5 HOR	205799	160x1.2x32 т.2 z80 P6M5 HOR	205847	200x2.5x32 т.3 z26 P6M5 HOR
205744	125x2.5x22 т.3 z20 P6M5 HOR	205800	160x1.4x32 т.1 z160 P6M5 HOR	205846	200x2.5x32 т.3 z40 P6M5 HOR
205743	125x2.5x22 т.3 z24 P6M5 HOR	205801	160x1.4x32 т.2 z80 P6M5 HOR	205848	200x2.8x32 т.1 z160 P6M5 HOR
205777	125x2.5x27 т.1 z100 P6M5 HOR	205802	160x1.6x32 т.1 z160 P6M5 HOR	205849	200x2.8x32 т.2 z80 P6M5 HOR
205778	125x2.5x27 т.2 z48 P6M5 HOR	205803	160x1.6x32 т.2 z80 P6M5 HOR	205850	200x3x32 т.1 z128 P6M5 HOR
205780	125x2.5x27 т.3 z20 P6M5 HOR	205804	160x1.6x32 т.3 z40 P6M5 HOR	205851	200x3x32 т.2 z64 P6M5 HOR
205779	125x2.5x27 т.3 z24 P6M5 HOR	205805	160x2x32 т.1 z128 P6M5 HOR	205853	200x3x32 т.3 z32 P6M5 HOR
205745	125x2.8x22 т.1 z100 P6M5 HOR	205806	160x2x32 т.2 z64 P6M5 HOR	205857	200x3.5x32 т.1 z128 P6M5 HOR
205746	125x2.8x22 т.2 z48 P6M5 HOR	205808	160x2x32 т.3 z22 P6M5 HOR	206306	200x3.5x32 т.2 z64 P6M5 HOR
205781	125x2.8x27 т.1 z100 P6M5 HOR	205807	160x2x32 т.3 z32 P6M5 HOR	206307	200x3.5x32 т.3 z32 P6M5 HOR
205782	125x2.8x27 т.2 z48 P6M5 HOR	205809	160x2.5x32 т.1 z128 P6M5 HOR	206308	200x4x32 т.1 z128 P6M5 HOR

КОД	МОДЕЛЬ	КОД	МОДЕЛЬ
206309	200x4x32 т.2 z64 P6M5 HOR	206364	315x4x40 т.1 z160 P6M5 HOR
206310	200x4x32 т.3 z32 P6M5 HOR	206365	315x4x40 т.2 z80 P6M5 HOR
206312	200x4.5x32 т.2 z64 P6M5 HOR	206367	315x4.5x40 т.2 z80 P6M5 HOR
206313	200x4.5x32 т.3 z32 P6M5 HOR	206368	315x5x40 т.1 z160 P6M5 HOR
206315	200x5x32 т.1 z128 P6M5 HOR	206369	315x5x40 т.2 z80 P6M5 HOR
206316	200x5x32 т.2 z64 P6M5 HOR	206371	315x5.5x40 т.2 z80 P6M5 HOR
206317	200x5x32 т.3 z32 P6M5 HOR	206373	315x6x40 т.1 z160 P6M5 HOR
206319	200x5.5x32 т.2 z64 P6M5 HOR	206374	315x6x40 т.2 z80 P6M5 HOR
206320	200x6x32 т.1 z100 P6M5 HOR		
206321	200x6x32 т.2 z48 P6M5 HOR		
206322	250x2x32 т.1 z200 P6M5 HOR		
206323	250x2x32 т.2 z100 P6M5 HOR		
206324	250x2.5x32 т.1 z160 P6M5 HOR		
206325	250x2.5x32 т.2 z80 P6M5 HOR		
206326	250x2.5x32 т.3 z40 P6M5 HOR		
206329	250x2.8x32 т.1 z160 P6M5 HOR		
206330	250x2.8x32 т.2 z80 P6M5 HOR		
206331	250x3x32 т.1 z160 P6M5 HOR		
206333	250x3x32 т.2 z80 P6M5 HOR		
206334	250x3x32 т.3 z40 P6M5 HOR		
206336	250x3.5x32 т.2 z80 P6M5 HOR		
206337	250x3.5x32 т.3 z40 P6M5 HOR		
206339	250x4x32 т.1 z160 P6M5 HOR		
206340	250x4x32 т.2 z80 P6M5 HOR		
206341	250x4x32 т.3 z40 P6M5 HOR		
206343	250x4.5x32 т.2 z80 P6M5 HOR		
206344	250x4.5x32 т.3 z40 P6M5 HOR		
206346	250x5x32 т.1 z128 P6M5 HOR		
206347	250x5x32 т.2 z64 P6M5 HOR		
206348	250x5x32 т.3 z32 P6M5 HOR		
206350	250x5.5x32 т.2 z64 P6M5 HOR		
206351	250x5.5x32 т.3 z32 P6M5 HOR		
206352	250x6x32 т.1 z128 P6M5 HOR		
206353	250x6x32 т.2 z64 P6M5 HOR		
206354	250x6x32 т.3 z32 P6M5 HOR		
206355	315x2.5x40 т.1 z200 P6M5 HOR		
206356	315x2.5x40 т.2 z100 P6M5 HOR		
206358	315x2.8x40 т.1 z200 P6M5 HOR		
206359	315x2.8x40 т.2 z100 P6M5 HOR		
206360	315x3x40 т.1 z200 P6M5 HOR		
206361	315x3x40 т.2 z100 P6M5 HOR		
206363	315x3.5x40 т.2 z100 P6M5 HOR		

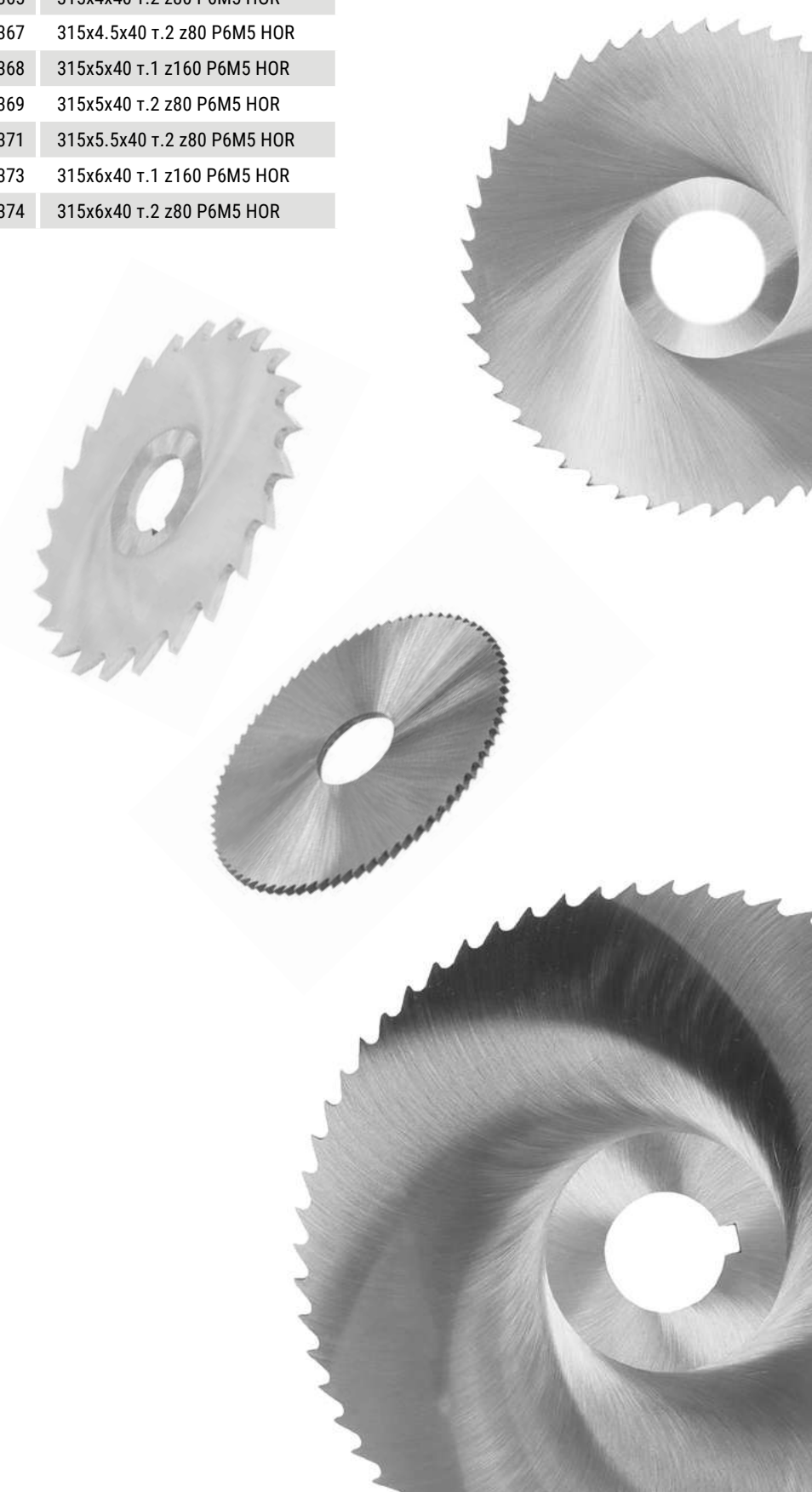



ФРЕЗЫ ШПОНОЧНЫЕ Ц/Х HORTZ

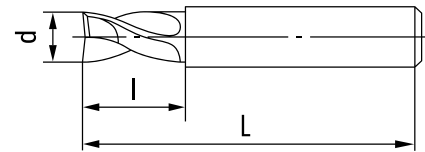

Материал: быстрорежущая сталь P6M5 ГОСТ 9140-78

КОД	d	L	l	КОД	d	L	l
351943	3	37	5	351951	14	73	16
351944	4	39	7	351952	16	79	19
351945	5	42	8	351953	18	79	19
351946	6	52	8	351954	20	88	22
351947	7	54	10	351955	22	88	22
351948	8	55	11	351956	25	102	26
351949	10	63	13	351957	28	102	27
351950	12	73	16				



ФРЕЗЫ ШПОНОЧНЫЕ К/Х HORTZ

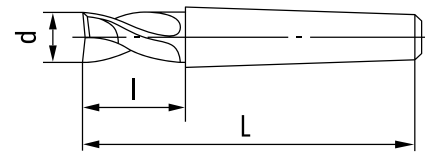

Материал: быстрорежущая сталь P6M5 ГОСТ 9140-78

КОД	d	L	l	КМ	КОД	d	L	l	КМ
351924	10	83	13	1	351934	22	124	22	3
351925	12	86	16	1	351935	25	128	26	3
351926	12	101	16	2	351936	28	128	26	3
351927	14	86	16	1	351937	32	134	32	3
351928	14	101	16	2	351938	32	157	32	4
351929	16	104	16	2	351939	36	134	32	3
351930	18	104	19	2	351940	36	157	32	4
351931	20	107	22	2	351941	40	163	38	4
351932	20	124	22	3	351942	40	195	60	5
351933	22	107	22	2					



ТИСКИ СТАНОЧНЫЕ ПОВОРОТНЫЕ (ТИП А) С РУЧНЫМ ПРИВОДОМ, ИСПОЛНЕНИЕ 2 HORTZ

ГОСТ 16518-96

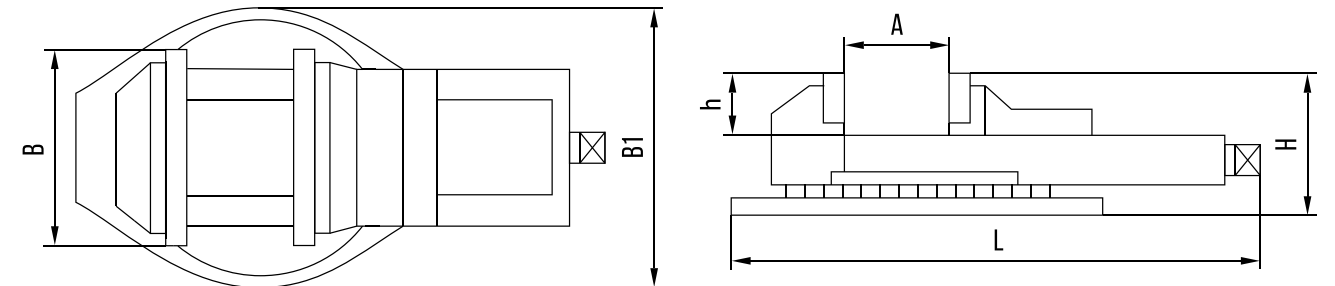

КОД	ШИРИНА ГУБОК, В	ВЫСОТА ГУБОК, h	ХОД ГУБОК, А	МАКСИМАЛЬНОЕ УСИЛИЕ ЗАЖИМА	ГАБАРИТНЫЕ РАЗМЕРЫ, ДхШхВ, LxB1xH	МАССА
104462	125	40	95	24	297x166x126	14
104463	160	52	120	29	411x222x166	28
104464	200	63	150	34	453x242x183	38
104465	250	64	270	40	573x290x189	48
104466	320	81	350	54	695x360x206	69

