

Трубчатые кабельные наконечники с насечками, стандартная серия

HUPtype

- из трубки, отожжённый материал • поверхность: лужёная • материал: 99,9% электролитная медь E-CU DIN 40500
- для многожильных кабелей круглого сечения, напр., VDE 0295 класс 2
- для кругло-сжатых секторных проводов
- Проверка на вибропрочность DIN EN 61373:1999-11, кат. 1, кл. B



Cu

имеются в продаже с и без смотрового отверстия, например, 29 00 04/S (При заказе добавить xx xx xx/s)

№ арт.	ПСП	M	d2	d1	d4	A	v1	v2	Д	B	c1	c2	Kr/100	шт	YE	
290004	120	8	8,5	15,0	19,5	26,0	2	1	51,0	28,0	14,0	14,0	6,300	20	15	
290006	*	10	10,5	15,0	19,5	26,0	2	1	51,0	28,0	14,0	14,0	6,200	80	15	
290008	*	12	13,0	15,0	19,5	26,0	2	1	51,0	28,0	14,0	14,0	6,100	80	15	
290009		14	15,0	15,0	19,5	26,0	2	1	52,0	28,0	15,0	15,0	5,900	72	18	
290010		16	17,0	15,0	19,5	26,0	2	1	54,0	30,0	16,0	16,0	6,200	60	15	
290012		20	21,0	15,0	19,5	26,0	2	1	63,0	36,0	22,0	22,0	7,900	60	15	
290014	150	10	10,5	16,5	21,0	30,0	2	1	56,0	31,0	14,0	14,0	7,500	60	15	
290016	*	12	13,0	16,5	21,0	30,0	2	1	57,0	31,0	15,0	15,0	7,300	60	15	
290017		14	15,0	16,5	21,0	30,0	2	1	57,0	31,0	15,0	15,0	7,900	60	15	
290018		16	17,0	16,5	21,0	30,0	2	1	58,0	31,0	16,0	16,0	7,500	60	15	
290020		20	21,0	16,5	21,0	30,0	2	1	66,0	36,0	22,0	22,0	8,800	48	12	
290022	*	185	12	13,0	19,0	24,0	30,0	2	1	65,0	35,0	18,0	18,0	11,100	40	20
290023		14	15,0	19,0	24,0	30,0	2	1	65,0	35,0	18,0	18,0	11,800	40	20	
290024	*	16	17,0	19,0	24,0	30,0	2	1	65,0	35,0	18,0	18,0	10,700	40	20	
290026		20	21,0	19,0	24,0	30,0	2	1	69,0	39,0	22,0	22,0	10,700	40	20	
290028	*	240	12	13,0	21,0	26,0	35,0	4	2	72,0	39,0	21,5	19,0	13,700	30	15
290029		14	15,0	21,0	26,0	35,0	4	2	72,0	39,0	21,5	19,0	13,400	30	15	
290030	*	16	17,0	21,0	26,0	35,0	4	2	72,0	39,0	21,5	19,0	13,400	30	15	
290034	300	12	13,0	23,5	29,5	44,0	4	2	87,0	43,0	24,0	24,0	22,000	16	8	
290036		14	15,0	23,5	29,5	44,0	4	2	87,0	43,0	24,0	24,0	21,700	16	8	
290038		16	17,0	23,5	29,5	44,0	4	2	87,0	43,0	24,0	24,0	21,300	16	8	
290040		20	21,0	23,5	29,5	44,0	4	2	87,0	43,0	24,0	24,0	21,400	16	8	
290046	400	16	17,0	27,0	34,0	44,0	4	2	90,0	49,0	24,0	24,0	31,800	10	5	
290048		20	21,0	27,0	34,0	44,0	4	2	90,0	49,0	24,0	24,0	30,500	10	5	
290041	500	16	17,0	31,0	38,0	70,0	4	2	103,0	55,0	24,0	24,0	45,000	12	6	
290043		20	21,0	31,0	38,0	70,0	4	2	103,0	55,0	24,0	24,0	45,000	12	6	
290045	625	16	17,0	34,0	41,0	70,0	4	2	108,0	60,0	24,0	24,0	49,200	6	3	
290047		20	21,0	34,0	41,0	70,0	4	2	108,0	60,0	24,0	24,0	49,200	6	3	

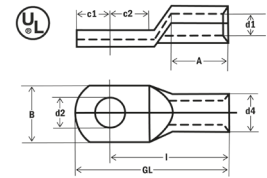

Brunel
access to excellence

Трубчатые кабельные наконечники с насечками, стандартная серия 90°

HUPtype

- из трубки, отожжённый материал • поверхность: лужёная
- материал: 99,9% электролитная медь E-CU DIN 40500
- для многожильных кабелей круглого сечения, напр., VDE 0295 класс 2
- для кругло-сжатых секторных проводов



Cu

№ арт.	ПСП	M	d2	d1	d4	A	v1	v2	Д	B	c1	c2	Kr/100	шт	YE
290932/90	6	5	5,3	3,5	6,5	9,0	1	-	21,0	10,0	6,5	7,5	0,475	1800	100
290934/90		6	6,5	3,5	6,5	9,0	1	-	21,0	12,0	6,5	7,5	0,400	1400	100
290936/90		8	8,5	3,5	6,5	9,0	1	-	23,0	15,0	10,0	10,0	0,500	1400	100
290938/90	10	5	5,3	4,5	7,0	10,0	1	-	22,0	12,0	6,5	7,5	0,400	1000	100
290940/90		6	6,5	4,5	7,0	10,0	1	-	22,0	12,0	6,5	7,5	50,000	1000	100
290942/90		8	8,5	4,5	7,0	10,0	1	-	25,0	15,0	10,0	10,0	0,540	800	100
290944/90		10	10,5	4,5	7,0	10,0	1	-	27,0	17,0	12,0	12,0	0,573	600	100
290948/90	16	5	5,3	5,5	8,5	13,0	1	1	26,0	12,0	5,5	6,5	0,800	600	100
290950/90		6	6,5	5,5	8,5	13,0	1	1	27,0	12,0	6,25	7,5	0,700	600	100
290952/90		8	8,5	5,5	8,5	13,0	1	1	29,0	15,0	8,5	9,5	0,800	400	100
290954/90		10	10,5	5,5	8,5	13,0	1	1	31,0	17,0	10,5	11,5	0,950	400	100
290956/90		12	13,0	5,5	8,5	13,0	1	1	33,0	19,0	12,0	13,0	1,000	400	100
290958/90	25	6	6,5	7,0	10,0	15,0	2	1	30,0	14,0	7,5	7,5	1,100	400	50
290960/90		8	8,5	7,0	10,0	15,0	2	1	32,0	16,0	10,0	10,0	1,200	400	50
290962/90		10	10,5	7,0	10,0	15,0	2	1	34,0	18,0	12,0	12,0	1,250	300	50
290964/90		12	13,0	7,0	10,0	15,0	2	1	35,0	19,0	13,0	13,0	1,300	300	50

